

ONLY HOUSE

Our vision –
help people in vulnerable situations to a dignified living



Meta&Morphe

Module systems for light, flexib

LUNO House is a module house consisting of glass fibre reinforced sandwich panels with good insulation put together with specially designed aluminium profiles.

The advantage of LUNO house is the exceptional durability, the high strength and very easy to assemble.

The house is mounted on base plates, which are adjustable from the inside of the house. Normally no prior preparation of the ground is necessary.

LUNO House can be used in emergency areas i.e. camps, hospitals, school buildings etc.

With LUNO House the hygiene and comfort is essentially improved and offers a dignified standard of living.

The house has a low weight and is designed in such a way that it is easily shipped in containers or on flight pallets.



Each house is built with floor- and ceiling panels of 2 x 2 m and wall panels with 2 x 2,3 m.

The metals are re-usable and the plastic is a waste product.

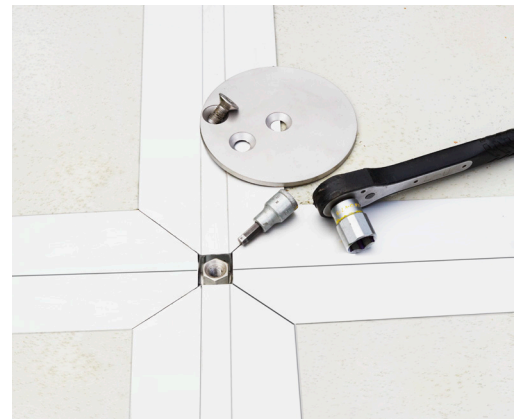
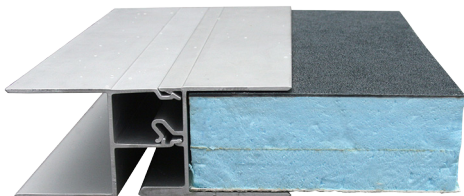

Use the wall as a white board

le buildings in rough conditions

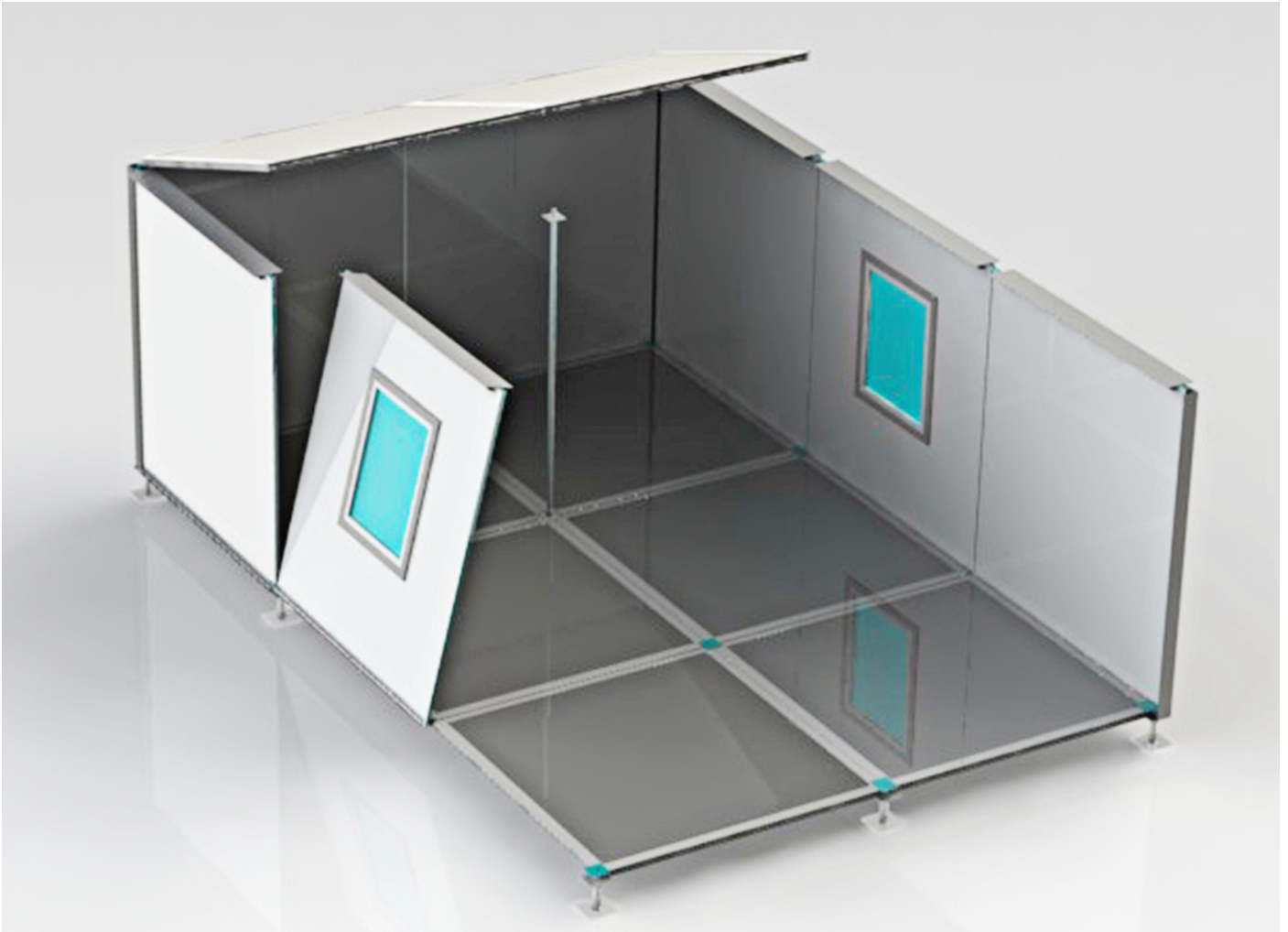

Why LUNO House

DURABILITY

- Excellent insulation.

FLEXIBILITY

- The low weight makes transportation easier to areas difficult to reach.

SIMPLICITY

- The units are fast to assemble.
4-6 hours for skilled personnel.

Specification of a standard house – Technical information

Area 26 square metre.

Weight Around 1000 kg.

Modules Each house is built of 6 floor panels, 6 ceiling panels and 10 wall panels (including 1 door and 2 opening windows).

Roof The roof is made of two layers flame resistant PVC and is generally light grey.

Options National or international humanitarian organizations flag patterns or a company logo can be applied on the roof covering for a additional charge.

The company Meta&Morphe AB was established in Olofström, Blekinge, Sweden in 1993 by Lars-Uno Nilsson. Lars-Uno began his career installing electrical services in Sweden as well as internationally.

Lars-Uno started this project, LUNO House when he became aware that many different humanitarian organizations were looking for an alternative to the tents normally used in emergency humanitarian situations. The tents used today can not and do not provide a sufficient level of hygiene or shelter that is necessary against the wide variety of weather situations which are regularly encountered.

LUNO House fulfils most of the criterias necessary to address and improve the conditions of refugees in these areas.

Meta&Morphe AB has developed a new system using modular construction techniques for the provision of temporary units that can be used as houses and/or other buildings in emergency areas. The units can be put together in a variety of sizes depending on its purpose.

The LUNO House can however also be used in non-emergency situations for a wide range areas such as temporary accommodation modules and can even be built as sheds, mountain lodges, hunting towers – the possibilities are endless!

Meta&Morphe

Dannefeldtsvägen 24, SE-293 31 OLOFSTRÖM

Tel +46 723-17 05 45 or +46 708-50 28 87

Tel: +46 454-481 69 • Mobile: +46 706-39 51 67 • Fax: +46 454-481 69

www.metamorphe.eu